



## The Delight - Move In Ready!



### The Delight - Move In Ready!

Model number: 97TRS14602AH19

**2 beds • 2 baths • 840 sq.ft. • 14' width • 60' depth**

Our home building facilities invest in continuous product and process improvements. Plans, dimensions, features, materials, specifications and availability are subject to change without notice or obligation. Renderings and floor plans are representative likenesses of our homes and may differ from the actual homes. We invite you to tour a Home Center near you and inspect the highest value in quality housing available or call (361) 299-1442 to speak with a Home Consultant. Copyright 2017, CMH. All rights reserved.

<https://www.claytonhomescorpuschristi.com>

### CLAYTON HOMES- CORPUS CHRISTI

5858 LEOPARD STREET  
CORPUS CHRISTI, TX 78408

Monday - Thursday: 9am to 5pm  
Friday: 9am to 5pm  
Saturday: 9am to 5pm  
Sunday: Closed

(361) 299-1442



## The Delight - Move In Ready!

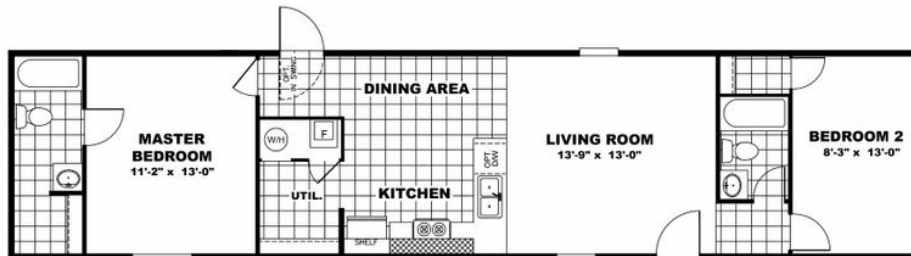

### The Delight - Move In Ready!

Model number: 97TRS14602AH19

**2 beds • 2 baths • 840 sq.ft. • 14' width • 60' depth**

Our home building facilities invest in continuous product and process improvements. Plans, dimensions, features, materials, specifications and availability are subject to change without notice or obligation. Renderings and floor plans are representative likenesses of our homes and may differ from the actual homes. We invite you to tour a Home Center near you and inspect the highest value in quality housing available or call (361) 299-1442 to speak with a Home Consultant. Copyright 2017, CMH. All rights reserved.

<https://www.claytonhomescorpuschristi.com>

#### CLAYTON HOMES- CORPUS CHRISTI

5858 LEOPARD STREET  
CORPUS CHRISTI, TX 78408

Monday - Thursday: 9am to 5pm

Friday: 9am to 5pm

Saturday: 9am to 5pm

Sunday: Closed

(361) 299-1442